

ANNEXE : INSTALLATION BOITIER ÉLECTRIQUE (OPTION LED)

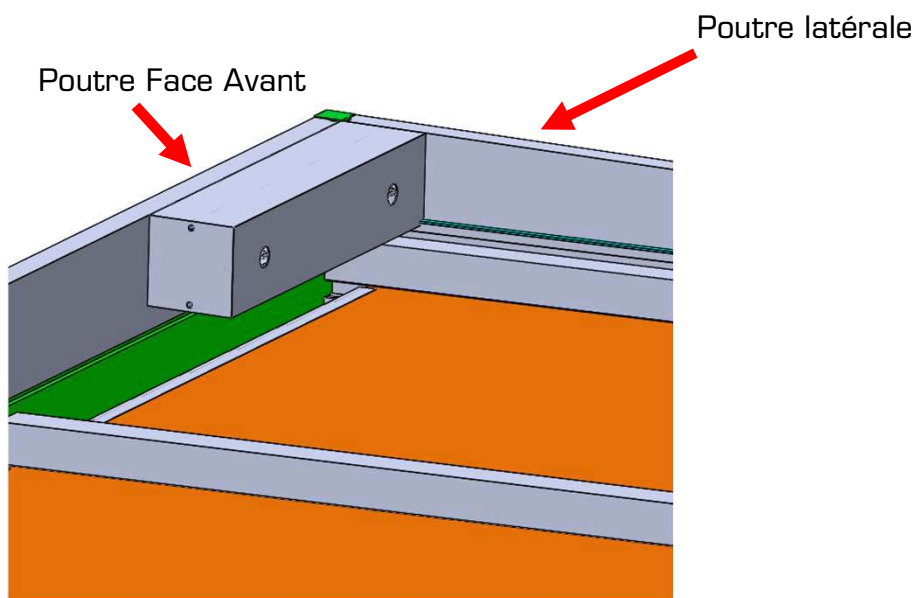

La boîte électrique est à implanter contre la poutre avant coté perçage Ø30mm

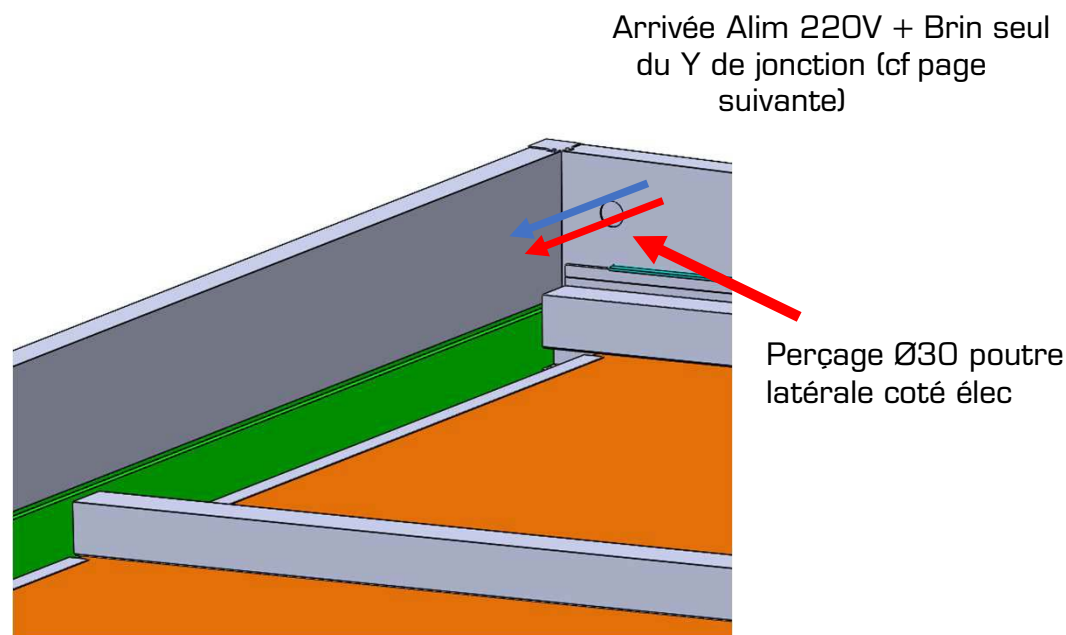

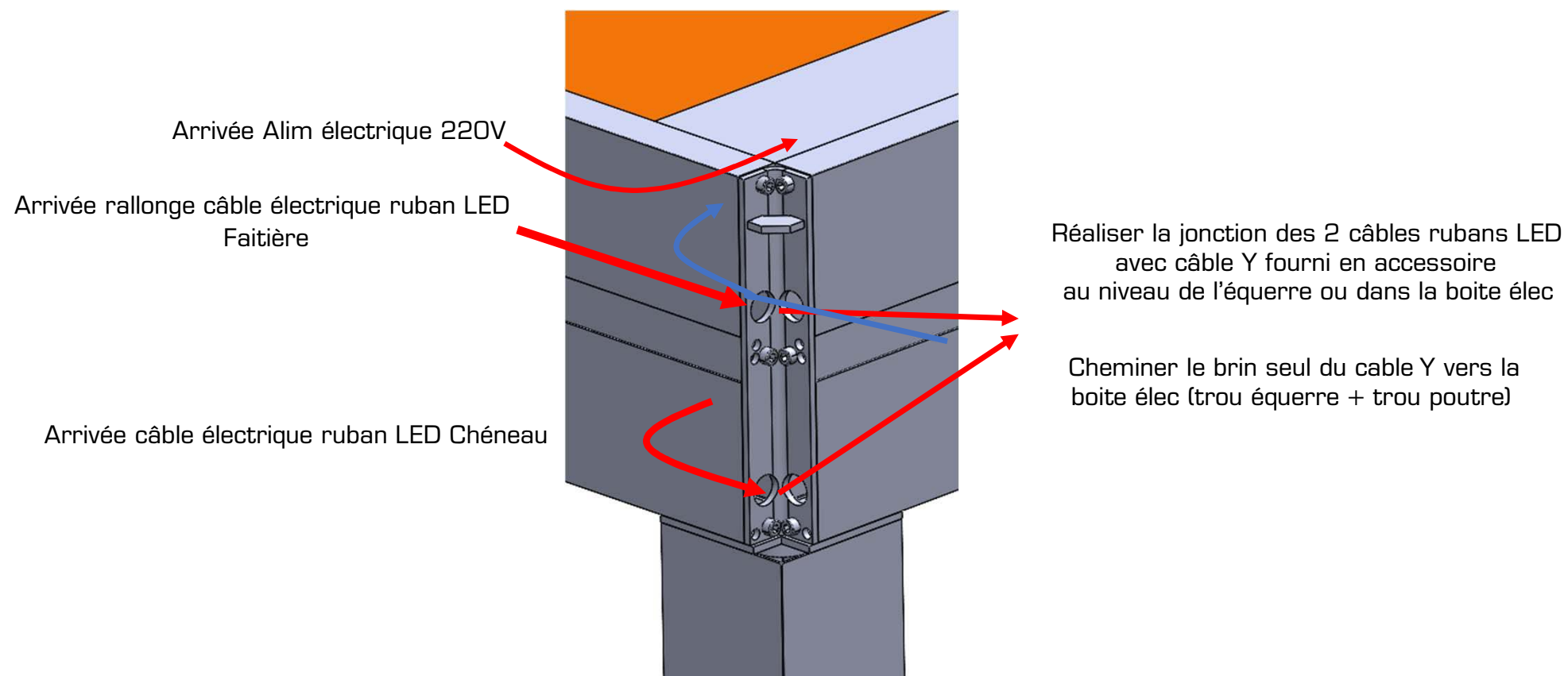

Raccordement du brin seul Y jonction au TV
stick (prise spécifique)
Raccordement alim 220V au TV stick
(WAGO + boîte plexo)

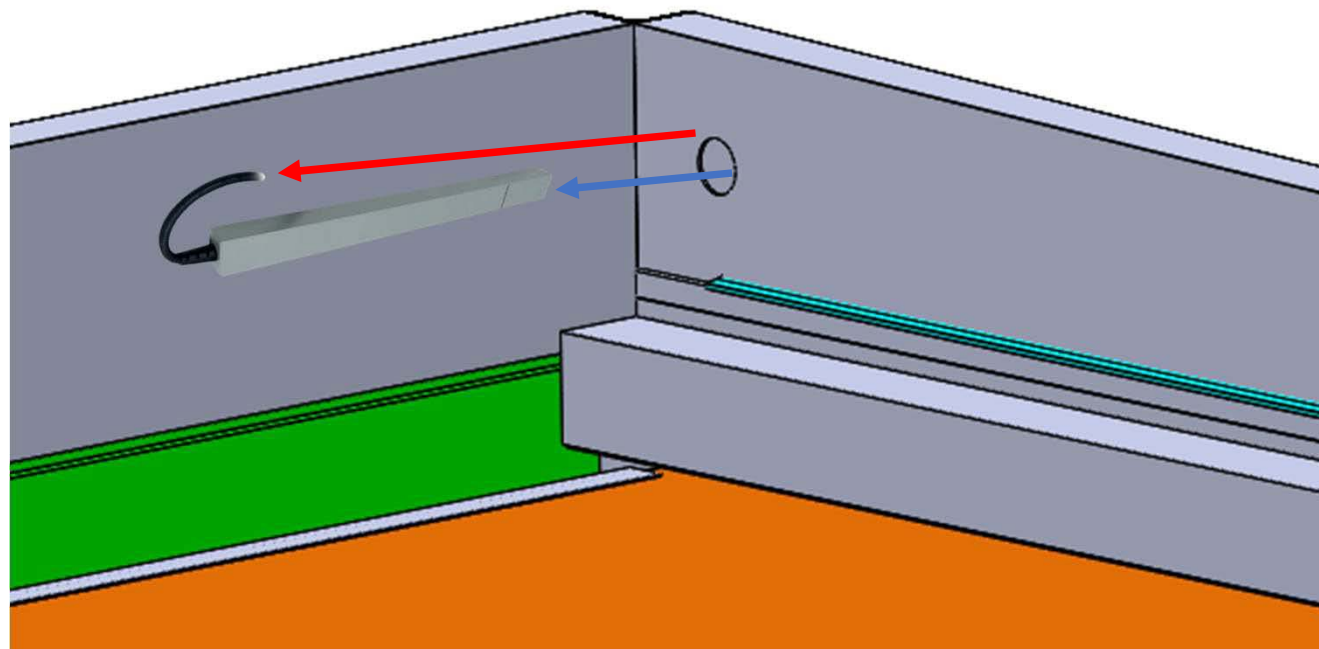

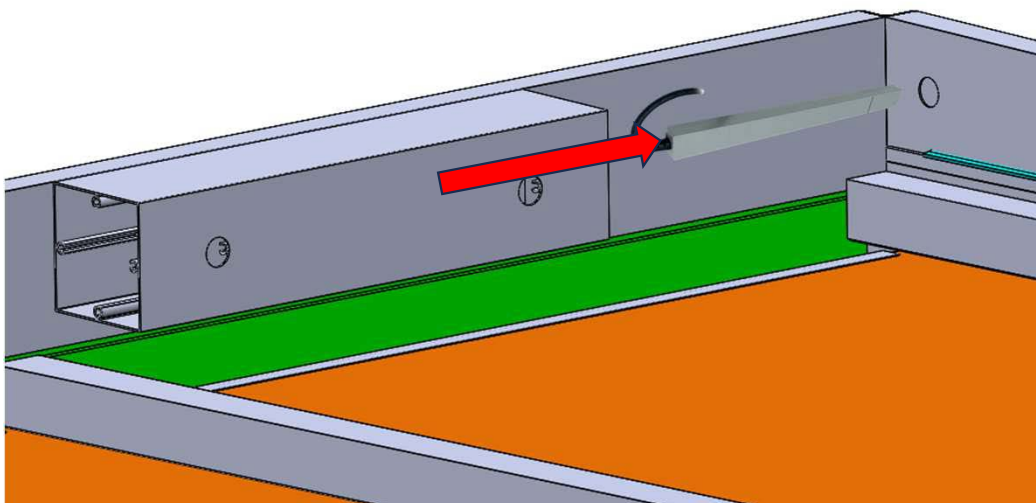

POSITION INITIALE

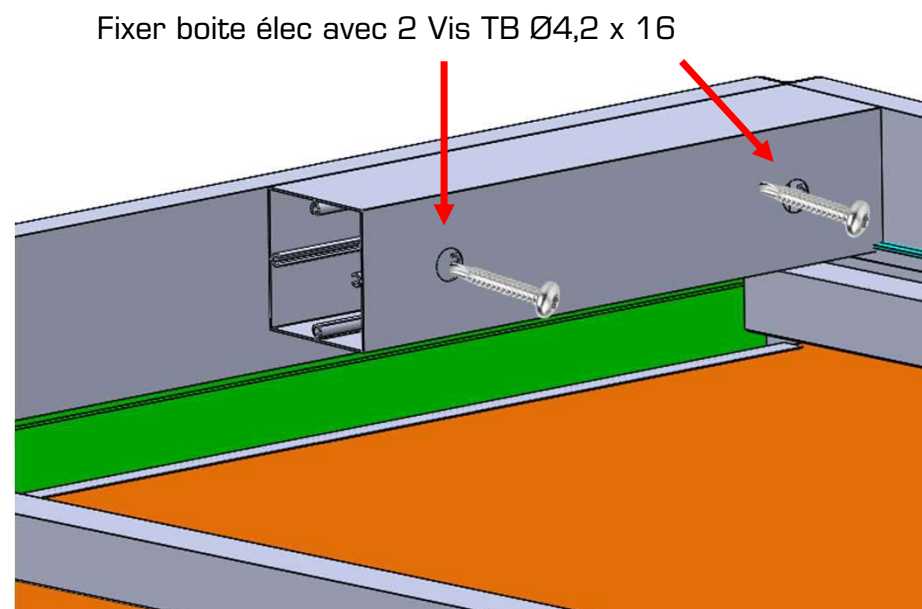

POSITION FINALE

MONTER 2 Bouchons affleurants plastique
Ø30

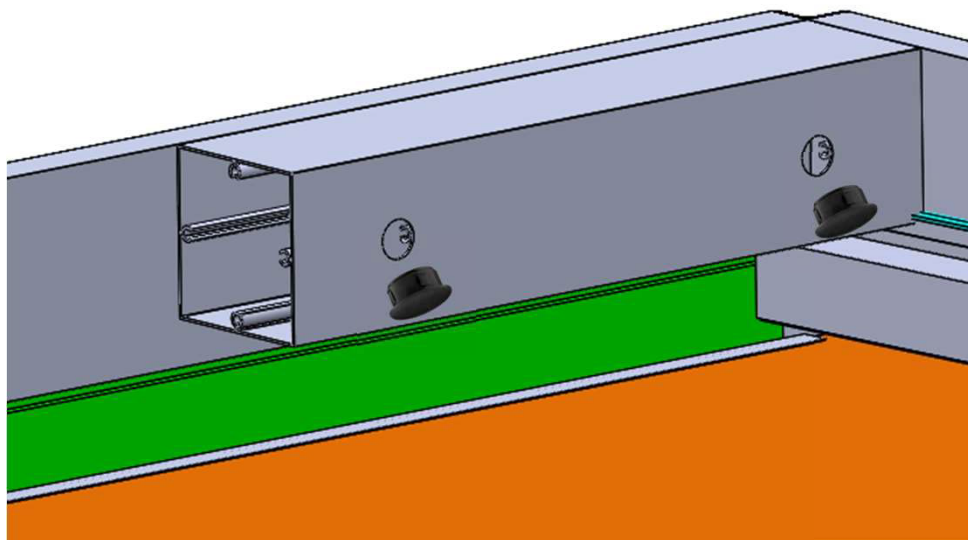

MONTER Embout boîte élec

2 Vis CHC M8x20

